

2006_Mar_NL

WELCOME TO THE VMF/VMA -311 REUNION 2006

MARINE FIGHTING SQUADRON-311

MARINE ATTACK SQUADRON -311



Hells Belles from World War II, Whiskey Lovers in Korea and Tomcats Viet Nam to Present

SAN DIEGO, CALIFORNIA

ON BEHALF OF THE REUNION COMMITTEE WE WELCOME YOU AND THANK YOU FOR YOUR PARTICIPATION IN REUNION 2006. WE BELIEVE WE HAVE PUT TOGETHER A FINE REUNION THAT IS AFFORDABLE AND ENJOYABLE. FOR THOSE OF YOU WHO HAVE NOT BEEN TO SAN DIEGO, OR SINCE MCRD, IT WILL BE A GRAND EXPERIENCE.

WE HAVE SCHEDULED TWO TOURS ONLY AND HAVE LEFT ENOUGH TIME FOR YOU TO SPEND WITH YOUR FRIENDS. WE ENCOURAGE YOU TO BRING YOUR FAMILIES AND CATCH SOME OF THE SIGHTS IN SAN DIEGO OTHER THAN THE TOURS. THE HOTEL DOES NOT RUN A SHUTTLE BUT EVERYTHING IS WITHIN REASONABLE TAXI RATE. USE CLOUD 9 SHUTTLE FOR SMALL GROUPS.

HOTEL RESERVATIONS: USE THESE NUMBERS TO RESERVE YOUR ROOMS. 1-877-DIEGO-4-U (1-877-343-4648) or 1-800-842-4242.

THE HOTEL NUMBER IS 619-296-2101. THE HOTEL SUITES ARE \$79.99 PLUS CITY TAX. EVERYONE WILL STAY IN THE MAIN HOTEL. THEY ARE UNDERGOING MAJOR RENOVATIONS AND THIS WILL BE ALL THAT IS COMPLETED. WE HAVE THE WHOLE HOTEL BLOCKED OFF. FILL EM' UP. USE CLOUD 9 SHUTTLE FROM THE AIRPORT. NO CHARGE. HOTEL IS HANDICAP ACCESSABLE.

GET YOUR RESERVATIONS IN EARLY. IF WE NEED MORE BUSES, WE CAN GET THEM.

WE WISH YOU A PLEASANT AND ENJOYABLE REUNION. TRAVEL SAFELY AND MAY GOD BLESS YOU.

SEMPER FIDELIS

Reunion2006Links

Lafayette Hotel & Suites San Diego <http://sandiego.innsuites.com/>

Reservations CALL 877.DIEGO.4.U (877-343-4648) Toll Free

or 800.468.3531 Toll Free

AGENDA FOR THE VMF/VMA-311 REUNION 2006 SAN DIEGO, CALIFORNIA 20-24 SEPTEMBER 2006

Wednesday Sept. 20,

Hospitality Room is open early for set up. Les and Bonita McMillan are Hosts.

Get your welcome packet. Come in for some refreshments. Bring your memorabilia.

Lunch, dinner, and sites are on your own. Hospitality room will remain open evenings after dinner until the cows come home. (The older we get the earlier they come home!!)

Thursday Sept. 21

Hospitality Room will be open if there is someone there to watch it.

Tour leaves for San Diego at 0700 and return 16-1700.

\$39.00 per person. Include's lunch. Dinner is on your own.

Friday Sept. 22

Hospitality Room opens if someone is going to watch it.

Tour to MCRD at 0700. We'll be present for the flag raising ceremonies at 0800 and watch recruit graduation at 1000.

Lunch at Duncan Hall with the troops and visit the Museum and whatever we can do.

Cost: \$25.00 per person. Does not include lunch. Arrive back at the hotel 14-1500.

Dinner is on your own.

Friday Night approx. 2000- Auction in banquet hall. Phantom Broker- Ralphie Reed, Auctioneer.

Saturday Sept. 23

Hospitality Room opens early.

A short business meeting will be held at 0800 in the hospitality room.
After the meeting, gather your memorabilia, so we can close up the hospitality room.
The Banquet will begin at 1800. Please bring your dinner selection ticket.
There will be a cash bar and music.

Dinner begins at 1900.

DJ will play until 2200.

Sunday Sept. 24

Check out of Hotel.

**HAVE A SAFE TRIP HOME! WILL SEE YOU AT THE NEXT
REUNION**

**VMF/VMA-311 TOMCATS REUNION 2006
REGISTRATION FORM
LAFAYETTE INN SUITES
SAN DIEGO, CALIFORNIA
20-24 SEPTEMBER 2006**

LIST NAME(S) AS YOU WANT TO APPEAR ON NAME TAGS.

LAST

FIRST

NAME _____

SPOUSE _____

OTHER _____

REGISTRATION NUMBER OF ATTENDEES: _____ X \$10.00 = _____

SAN DIEGO TOUR : _____ X \$39.00 = _____

MCRD TOUR: _____ X \$25.00= _____

BANQUET: _____ X \$50.00= _____

TOTAL= _____

ADDRESS: _____

CITY, STATE, ZIP: _____

WHAT YEARS WITH 311: _____ JOB OR CAPACITY: _____

PHONE: _____ EMAIL _____

**MAKE ALL CHECKS PAYABLE TO: VMF/VMA-311
REUNION ASSN.**

MAIL BANQUET FORM AND REGISTRATION FORM TO:

***JIM GALCHICK
1290 E. 12TH ST.
SALEM, OHIO 44460***

CALL ME AT 330-337-9383 OR EMAIL: jimsue@raex.com WITH ANY QUESTIONS.

BANQUET SELECTION FOR 23 SEPTEMBER 2006

CHOOSE FROM THE FOLLOWING ENTREES:

#1 - BEEF TENDERLOIN MEDALLIONS Succulent tenderloin slices topped with Maderia Demi-glaze

#2 - CHICKEN MARSELA Tender medallions of boneless breast with a rich Marsala and mushroom sauce.

#3 - (VEGETARIAN) STUFFED PORTABELLO MUSHROOM

MEALS INCLUDE:

ROASTED NEW POTATOES, HOUSE SALAD W/ CHOICE OF RANCH OR ITALIAN DRESSING,

FRESH VEGETABLE SAUTE, BAKERY FRESH ROLLS & BUTTER, COFFEE OR TEA,
CHOCOLATE LAYER CAKE W/ FRESH RASPBERRIES AND MINT GARNISH OR
FRESH FRUIT AVAILABLE FOR THOSE ON A SPECIAL DIET.

ALSO INCLUDED IS YOUR CHOICE OF CHARDONNEY OR CABERNET SAVAGNON WINE.

PLEASE SPECIFY ANY SPECIAL DIETARY CONCIDERATIONS ON THIS PAGE.

NAME: _____ ENTRÉE _____

All meals are one price. Price includes service charge and California sales tax.

**MAIL THIS COMPLETED FORM IN WITH YOUR
REGISTRATION.**

SEMPER FIDELIS

San Diego Map

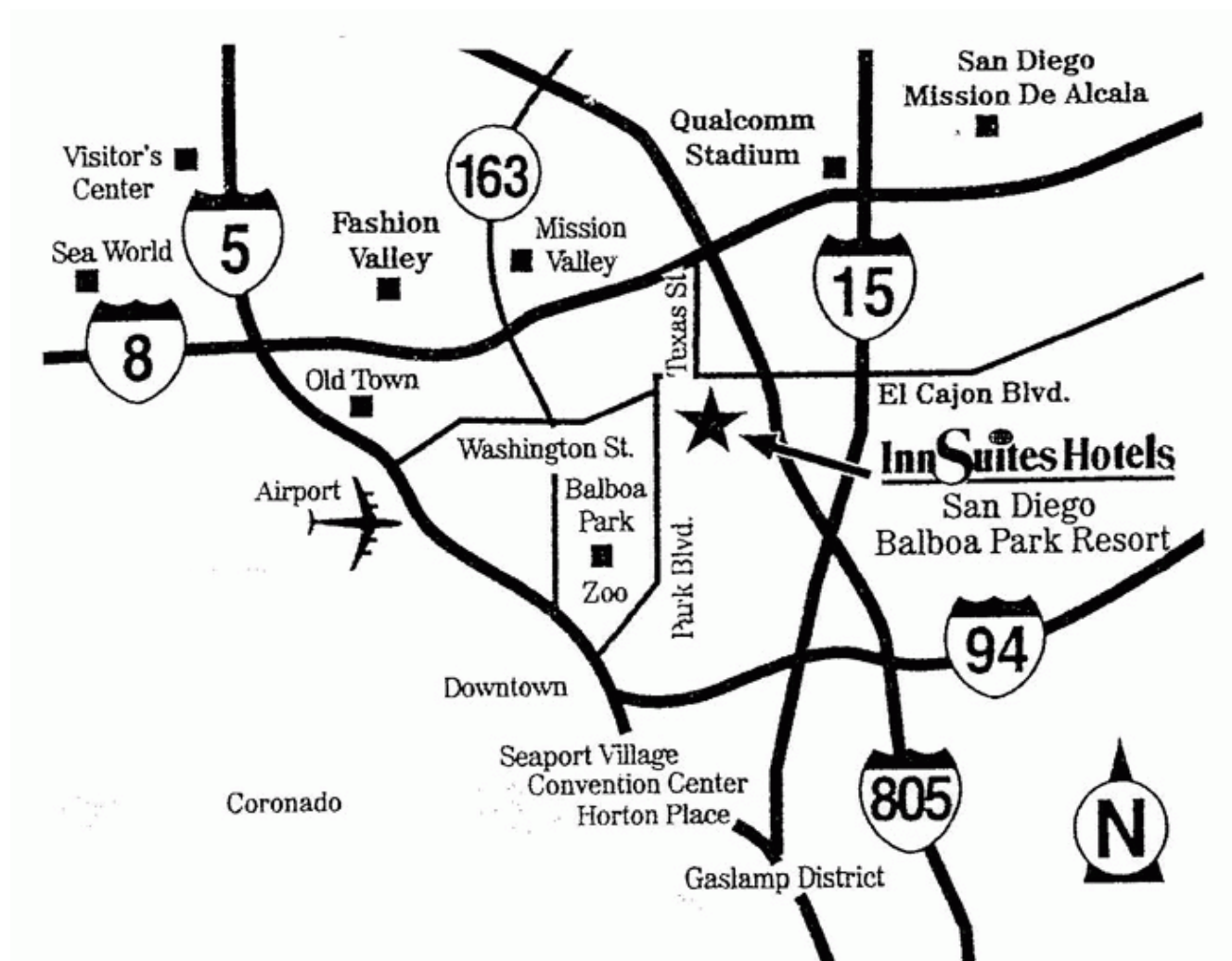

| | |
|---------------------------------|----------|
| San Diego Zoo/Balboa Park/ | 1 Mile |
| Old Globe Theatre | 1 Mile |
| Mission Bay Aquatic Park | 5 Miles |
| Historical Old Town San Diego | 4 Miles |
| Amtrack Station | 5 Miles |
| Downtown San Diego | 4 Miles |
| Convention Center | 5 Miles |
| Seaport Village | 5 Miles |
| SeaWorld | 6 Miles |
| Cruise Terminal | 5 Miles |
| Coronado Island and Beach | 7 Miles |
| San Diego International Airport | 5 Miles |
| Tijuana, Mexico | 15 Miles |
| White Sandy Beaches | 5 Miles |
| Wild Animal Park | 25 Miles |

Hotel Guest Informanion

COMPLIMENTARY BREAKFAST BUFFETT

Served from 6:30 a.m. to 10:00 a.m. in the Prs Cafe located off the Main Lobby.

Please enjoy food and beverages in breakfast areas only.

PARKING

We have 4 parking areas. 1 located on the west side of Louisiana Street; 1 at the back of the property on Howard Street; 1 on the east side of Mississippi Street; and the underground gated parting lot is located on Mississippi Street at the two while gates. Your room key will open the gate.

ICE MACHINES

We have two ice machines for your convenience. One is outside in the Pool Area on the East side of the patio area behind wall. The other is located on the Second Floor in between Room 236 & Room 238.

PUBLIC RESTROOM

Located off the Main Lobby in the west hallway.

COIN LAUNDRY ROOM

Located outside off the Breakfast Patio behind the Pr s Café through the gate going out to the parking lot on Louisiana Street. \$1.00 Wash / \$0.75 Dry

FITNESS CENTER and BUSINESS CENTER & LIBRARY

Located down the east hallway off the Lobby. The Business Center/Library is the second door on the right. The Fitness Center is the third door on the right Use your room key to enter. Hours for both are 7:00 a.m. 10:00 p.m.

PUBLIC TELEPHONE

Located off the lobby in the hallway leading to the Breakfast Patio area. \$0.50 local calls.

VENDING MACHINES

Located in the game room off the Main Lobby area; also located on the Pool Patio area next to the outside ice machine.

RED FOX RESTAURANT & LOUNGE

Located all the way down the west hallway off the Main Lobby area; it is the last door on the left. Or enter from outside at the corner of Louisiana Street and El Cajon Blvd. Serves American Cuisine for lunch and dinner. Hours: 11:00 a.m. - 2:00a.m. Monday-Saturday and 4:00 p.m. - 2:00 a.m. Sunday. Restaurant does not provide room service; however, you can order a To Go Order.

VOICE MAIL

To retrieve messages dial 370 and follow instructions.

WAKE-UP CALLS

To place awake-up call dial 370 and follow instructions or call the Front Desk

AREA DIRECTIONS & TRANSPORTATION

Information is available at the Front Desk.

POOL TOWELS

Available in pool area on a rolling cart If there are no towels left, please notify the Front Desk.

BAYOU CAFE in the LAFAYETTE HOTEL

ALL AMERICAN BREAKFAST

2 Egg Combo:

2 Eggs any style w/ toast,
juice, & coffee or tea \$4.50

2 Egg Breakfast:

2 Eggs any style with country potatoes
& choice of toast \$4.00

Add bacon, ham or sausage \$2.25

Add a third egg \$1.00

Omelets:

3 Egg Omelet served with country
potatoes & choice of toast

Select your combination of fillings:
bacon, ham, sausage, turkey, chicken
cheddar, swiss, jack cheese, tomatoes,
caramelized onions, peppers, zucchini,
mushrooms, spinach, olives

Plain Omelet \$5.75

2 Fillings \$7.75

Each Additional Filling \$1.25

California Continental Combo:

Toast or breakfast pastry served with
fruit cup, juice & coffee or tea \$4.50

Cereal Combo:

Oatmeal, Raisin Bran, Cheerios,
or Corn Flakes served with fruit cup,
juice & coffee or tea \$4.50

Belgium Waffle:

With butter & maple syrup \$4.00

With strawberries & cream... \$5.95

With 2 eggs & breakfast meat \$6.95

SIDES

Hot Oatmeal or Cold Cereal \$2.25

Fresh Fruit Cup \$2.00

Country Potatoes \$2.00

Assorted Fresh Pastries \$2.25

Toast \$1.25

Fresh Brewed Coffee or tea

(free refill) \$1.50

Juice (daily selection) \$1.65

Milk \$1.50

HOTEL GUEST BREAKFAST

Select one of the following combinations (no substitutions please)

Please present a Hotel issued breakfast coupon to your server

2 Egg Combo: Two eggs any style with toast, juice and coffee or tea

Cereal Combo: Bowl of cereal, fruit, juice and coffee or tea

California Continental Combo: Toast or breakfast pastry fruit,
juice and coffee or tea

Breakfast served 6:30 to 10:00 am

Lunch 10:00 am Dinner 5:00 to 9:00 pm

Bar Hours 10:00 am-10:00 pm

Hotel Map

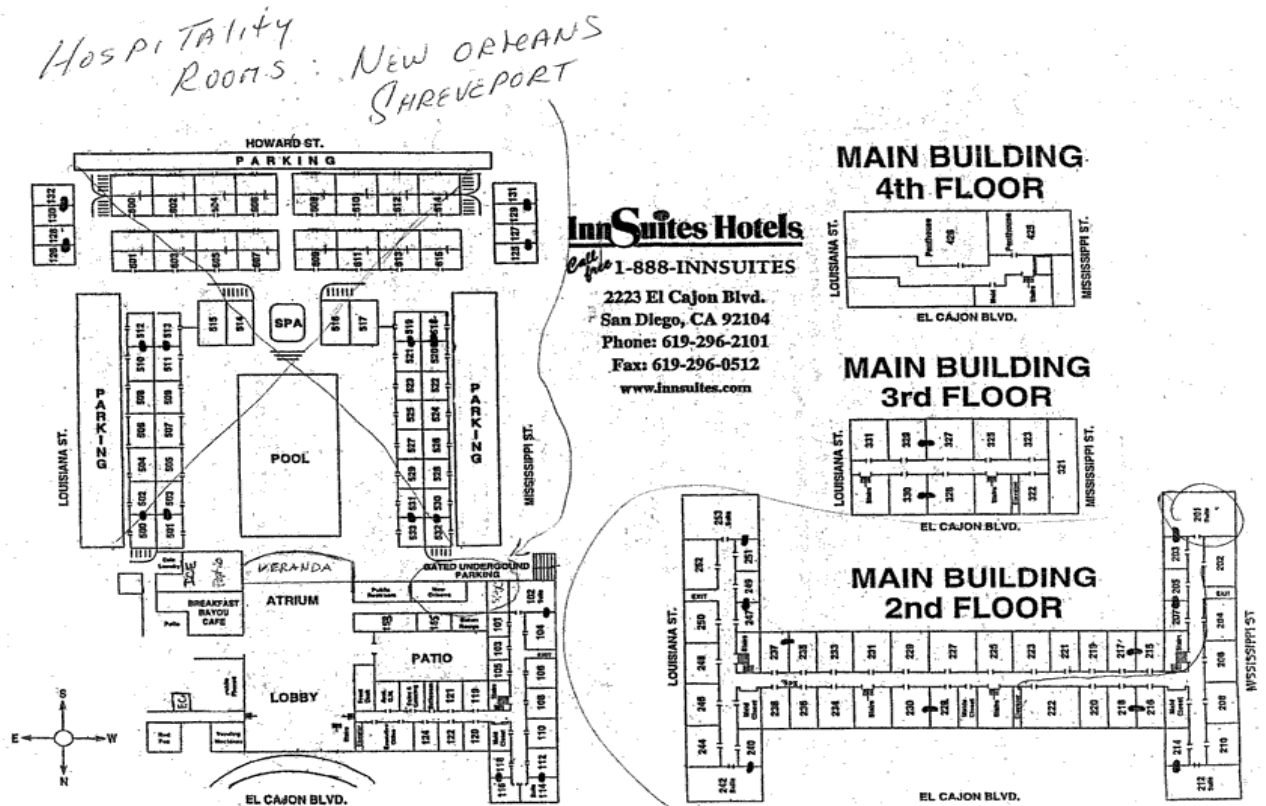

| | | |
|--|--|--|
| JIM & SUE GALCHICK | LES & BONITA MCMILLAN | GEORGE & JACKIE PHANDER |
| 1290 E. 12TH St. | 12479 EBY ROAD | 3032 POTSHOP ROAD |
| SALEM, OH 44460-1325 | CRESTON, OH 44217-9204 | NORRISTOWN, PA 19403-3819 |
| (333)337-9383 | (330)939-2827 | 610-584-5654 |
| jgalchick@neo.rr.com | bmcml@aol.com | piboxer@comcast.net |

Updated 7/28/2006 by FNT

Changed to pdf file 5/5/2009